

An aerial photograph of a highway interchange project. A central bridge spans across a multi-lane highway. To the left, a large interchange with a central pond is visible. The surrounding area is lush with green trees and some residential or commercial buildings in the distance. The sky is clear and bright.

I-95 & SR 896
INTERCHANGE PROJECT

Project Status/Ongoing Work

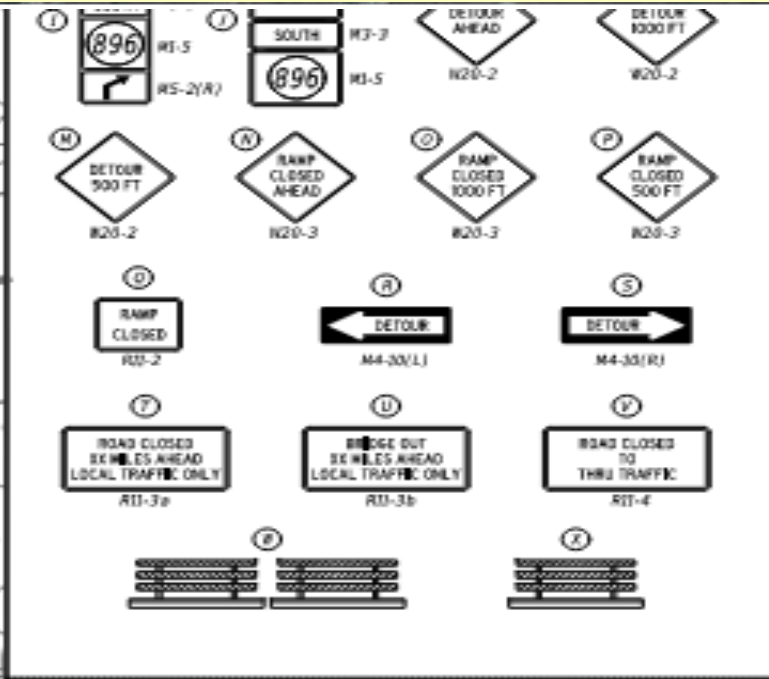
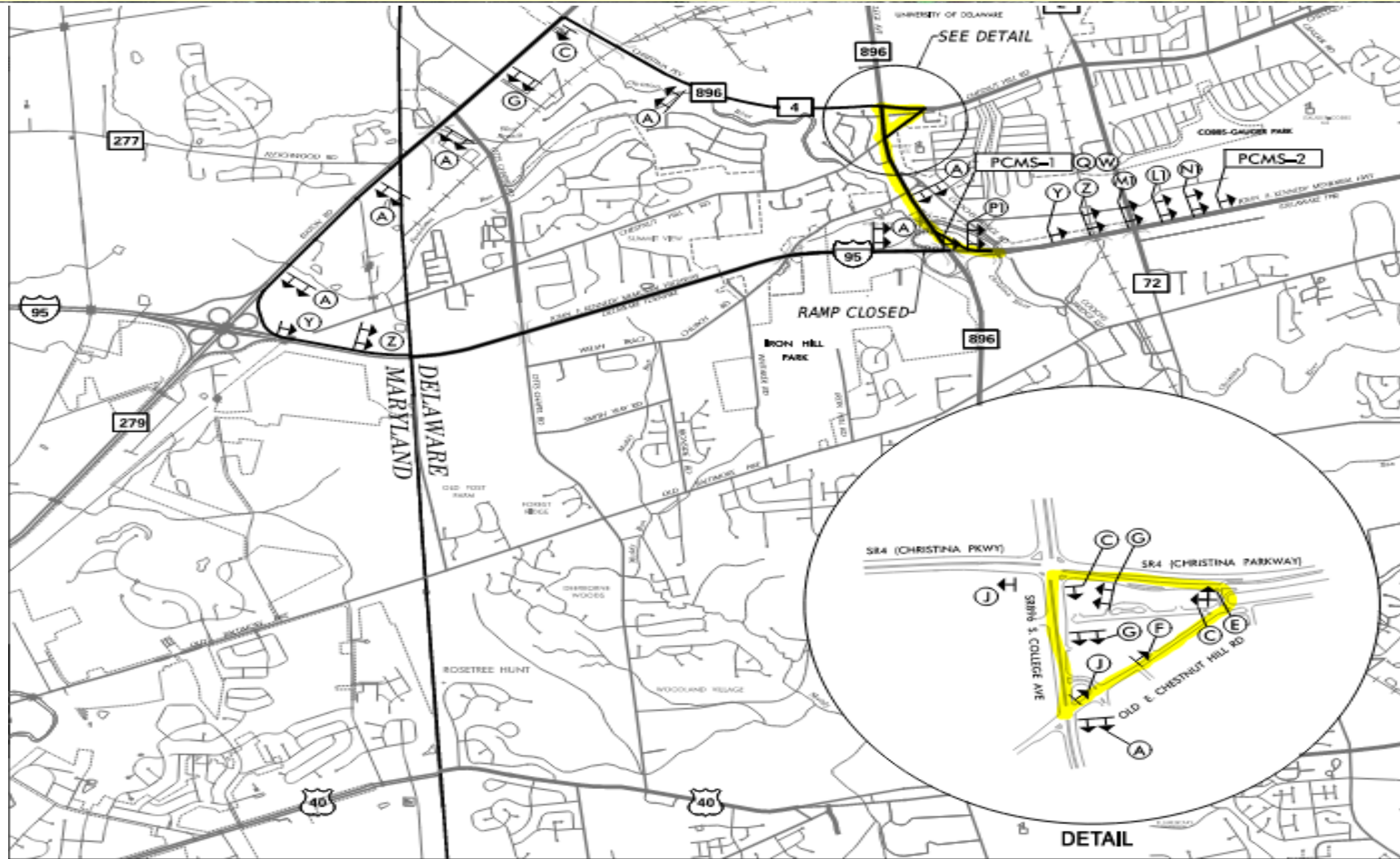

- GENERAL NOTES**
- ALL TEMPORARY TRAFFIC CONTROL DEVICES ARE TO BE SUPPLIED AND MAINTAINED BY THE GENERAL CONTRACTOR AND SHALL BE IN COMPLIANCE WITH THIS PLAN AND THE DELAWARE MANUAL ON UNIFORM TRAFFIC CONTROL DEVICES (DE MUTCD) LATEST EDITION.
 - SIGNS "W" THROUGH "O" AND "T" AND "V", THE WORD "ROAD" SHALL BE CHANGED TO "RAMP", "RR XING" OR "BRIDGE" WHERE APPLICABLE.
 - "W" TYPE 3 BARRICADES AT A ROAD CLOSURE SHALL BE PLACED COMPLETELY ACROSS THE ROADWAY, FROM CURB TO CURB, OR FROM EDGE OF ROAD TO EDGE OF ROADWAY, WITH THE STRIPES POSITIONED DOWNWARD TOWARD THE CENTER OF THE ROADWAY.
 - BARRICADES SHALL BE A MINIMUM OF 6 FEET WIDE UNLESS DIRECTED BY THE ENGINEER.
 - ALL SIGN ASSEMBLIES TO BE FABRICATED AS A SINGLE SIGN PANEL.
- DETOUR DESCRIPTION**
(TO BE USED ON ROAD CLOSURE NOTIFICATION AND TRAFFIC ALERT BY ENGINEER)
- MOTORISTS WANTING TO TRAVEL SOUTH ON SR896 (S. COLLEGE AVENUE) FROM I-95 SB WILL USE EXIT 1B AND CONTINUE ONTO SR 896 NB, TURN RIGHT ONTO SR4 (CHRISTINA PARKWAY), TURN RIGHT ONTO OLD E. CHESTNUT HILL ROAD, AND TURN LEFT RETURNING TO SR896 SB.

CONCURRENCE FOR IMPLEMENTATION
David P. Stapp 1-9-24
 TRAFFIC SAFETY DATE

NOA / REVISIONS	NOT TO SCALE	I-95 AND SR 896 INTERCHANGE	CONTRACT T20160962	PERMIT NO. X	VEHICULAR DETOUR PLAN PHASE 2B I-95 SB RAMP CLOSURE AT SB SR 896 (EXIT 1A / RAMP C)	SECTION WB
			COUNTY NEW CASTLE	DESIGNED BY WIGGINS		SHEET NO. 1375A
			CHECKED BY LARGAS			

NB/SB I-95 Temporary Closure at Exit 1 DETOUR







Predrilling and Rigid Inclusions in Area I



Caissons at Pier for
704A

Abutment B - 704 A
Begin MSE Walls 11&12

Abutment B - 705 A
Begin MSE Walls 8 & 9



Finish Construction of
Abut A - 703C and
Construct Pier

Bridge 649 B -
Excavate and Drive
H-Pile

Temporary Tower for
Erection of 703B

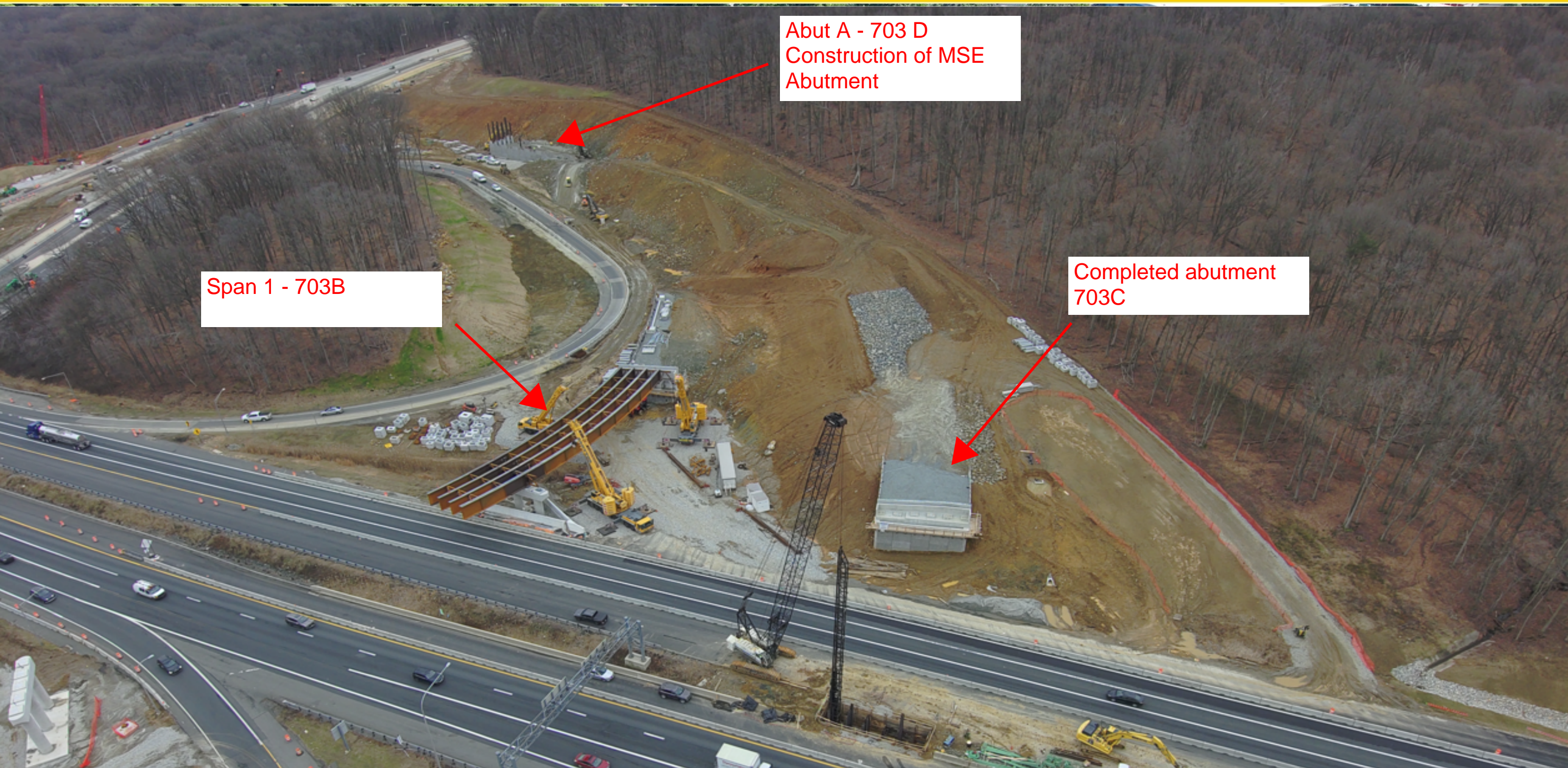

Abut A - 703 D
Construction of MSE
Abutment

Span 1 - 703B

Completed abutment
703C



Temporary SOE and
Micropile installation

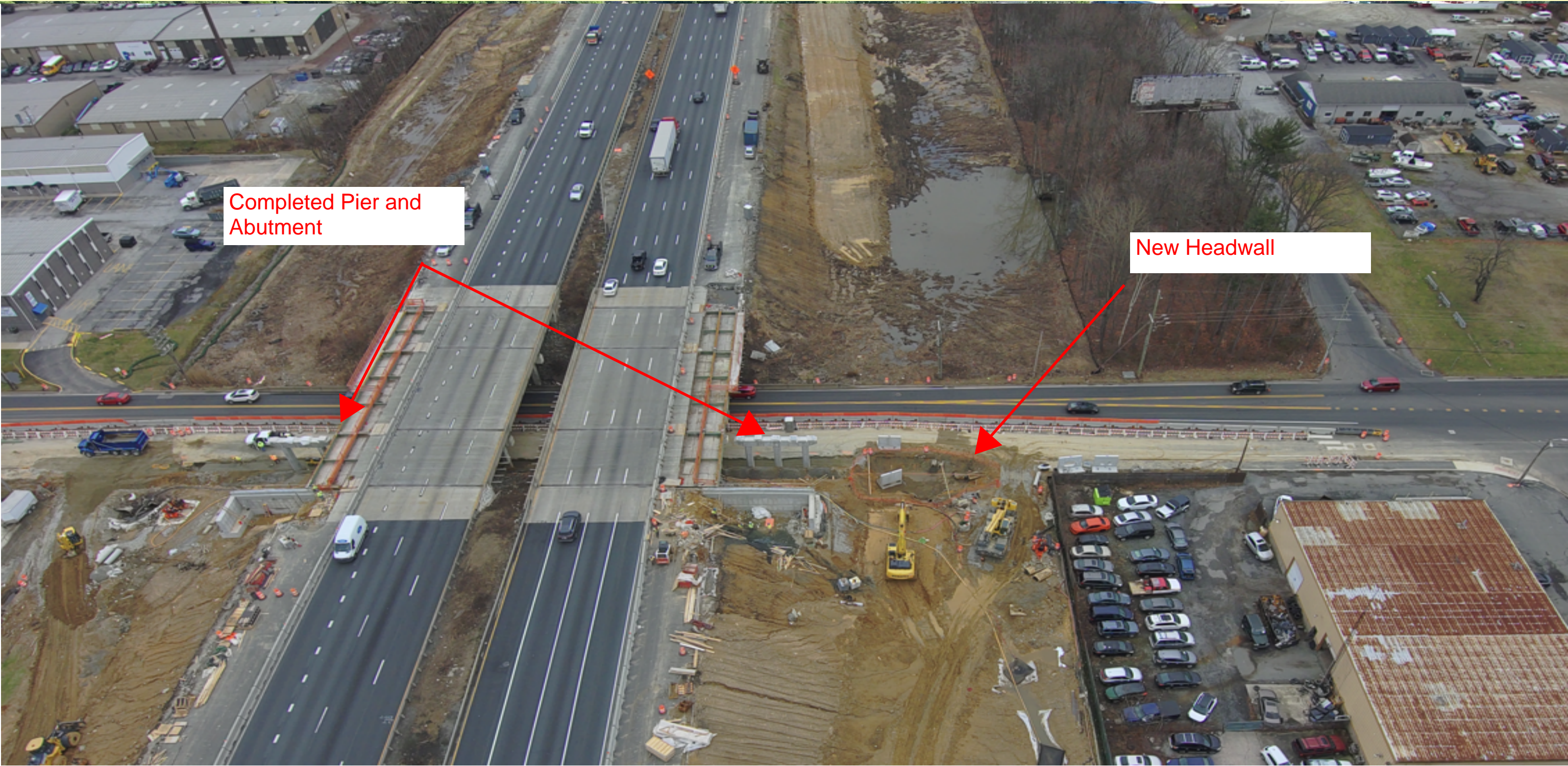

Completed Pier and Abutment

New Headwall